

Meet your phone.

SAMSUNG
Galaxy S9 | S9+

Para la versión en español, visite verizonwireless.com/Support

About your phone



NOTE: Devices and software are constantly evolving—the screen images and icons you see here are for reference only.

Setting up your phone

Your phone already has a SIM card installed.

Optional: Insert the microSD card

1. With the screen facing up, insert the tool that came with your phone into the hole on the SIM/microSD™ card tray to open it.
2. Carefully slide out the tray.
3. Insert the microSD card into the tray with the gold contacts facing down (as shown).
4. Carefully slide the tray back into place.



NOTE: microSD card sold separately.

Charge the Phone

Before turning on your phone, charge it fully.

Your phone comes with an Adaptive Fast Charging charger and a USB cable. Plug the smaller end of the cable into the USB/charger port on your phone and the larger end into the charger. Then plug the charger into an electrical outlet.



CAUTION: Use only charging devices that are approved by Samsung. Samsung accessories are designed for your device to maximize battery life. Using other accessories may void your warranty and may cause damage.

Using your phone

Turning your phone on/off

To turn your phone on, press and hold the **Power/Lock** button.

To turn your phone off, press and hold the **Power/Lock** button and follow the prompts.

Locking/Unlocking the screen

To turn on your screen, press the **Power/Lock** button and then swipe on the screen to unlock it.

To turn off your screen and prevent accidental key presses, press the **Power/Lock** button.

For added security, choose one of these other locking features:

- **Intelligent Scan:** Use both your face and irises to unlock your phone.
- **Fingerprint Scanner:** Use your fingerprint to unlock your phone.
- **Face Lock:** Have your phone unlock when it recognizes your face.
- **Iris Scanner:** Use your eyes to unlock your phone.

From the Home screen, swipe up for **Apps** and then tap **Settings > Lock screen and security** and choose your screen lock type. Then follow the onscreen instructions.

NOTE: The Iris Scanner is not intended to be used as a medical device and the biometric data collected and stored locally by the mechanism is not intended to be used for any diagnostic, therapeutic, or preventative purposes. Please follow all instructions for use of this feature. For more information, refer to the online support content or visit: Samsung.com/US/IrisScanner.

Home screen mode

You can select one of the two modes: Easy or Standard. Instructions in this guide are written using Standard mode.

Standard mode is for users who are familiar with Android™.

Easy mode is a simplified experience for the first-time smartphone user.

1. From the Home screen, swipe up for **Apps** and then tap **Settings > Display > Easy mode**.
2. Choose the mode you want to use and tap **APPLY**.





Using your phone

Edge screens

Edge screens deliver always-on access to text, email, notifications, news, and more.

To choose which Edge screen you want to use and customize the information it displays:

 >  From the Home screen, swipe up for **Apps** and then tap **Settings** > **Display** > **Edge screen**.

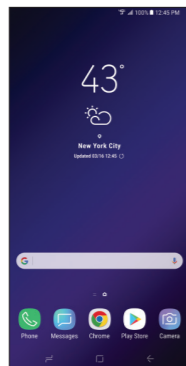

Edge handle
Swipe left to see notifications, missed calls, messages, calendar events, and much more.

Hello Bixby

To launch Hello Bixby, press the **Bixby** button.

Hello Bixby allows you to quickly set reminders, create voice dictation, search and access content on your phone and on the Internet.



Apps

Find new apps to download and install on your device.



Play Store: Download new apps from the Google Play store. Visit [Play.Google.com/Store/Apps](https://play.google.com/store/apps) to learn more.





Galaxy Apps: view and download Samsung apps that are optimized for use with Galaxy devices. Visit samsung.com/us/support/owners/app/galaxy-apps to learn more.

Copying content from your old phone

For help transferring contacts, photos, and other content from your old phone, visit verizonwireless.com/Cloud.

Or, transfer content using Smart Switch and the USB connector that came with your phone.

 >  From the Home screen, swipe up for **Apps** and then tap **Settings** > **Accounts** > **Smart Switch**.

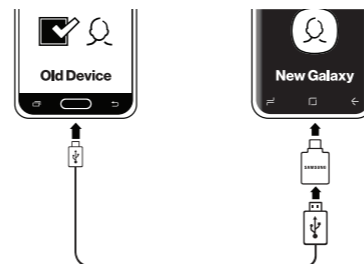

Learning more



Use the Help feature to access your device User Manual and other information on how to use your phone.



Making calls



Voicemail



Sending texts



Getting apps



Taking photos



Accessibility settings



To open the **Help** feature, from the Home screen, swipe up for **Apps** and then tap **Settings** > **Help**.



From your computer, visit verizonwireless.com/Support.



Download a User Guide from verizonwireless.com/Support or call **888.987.HELP** to order a copy.

Managing your account



My Verizon Mobile app

Manage your account, track your usage, edit account information, pay your bill, and more.



International travel

For features and rates when outside the US, visit: verizonwireless.com/International.



Customer service

Call **800.922.0204**
Twitter@VZWSupport

Additional information

Your wireless device and third-party services

Verizon Wireless is the mobile carrier associated with this wireless device, but many services and features offered through this device are provided by or in conjunction with third parties. Verizon Wireless is not responsible for your use of this device or any non-Verizon Wireless applications, services and products, including any personal information you choose to use, submit or share with others. Specific third-party terms and conditions, terms of use and privacy policies apply. Please review carefully all applicable terms, conditions and policies prior to using this wireless device and any associated application, product or service.

Hearing aid compatibility information

This phone has been tested and rated for use with hearing aids for some of the wireless technologies that it uses. However, there may be some newer technologies that have not been tested yet for use with hearing aids. It is important to try the different features of this phone thoroughly and in different locations, using your hearing aid or cochlear implant, to determine if you hear any interfering noise. Ask your service provider or the manufacturer of this phone for information on hearing aid compatibility. If you have questions about return or exchange policies, ask your service provider or phone retailer.

Samsung and Galaxy S9 and Galaxy S9+ are trademarks of Samsung Electronics Co., Ltd. Android, Google, the Google logo and Google Play are trademarks of Google LLC. Screen images simulated. Appearance of device may vary.

© 2018 Verizon Wireless. All Rights Reserved.

